

Project By

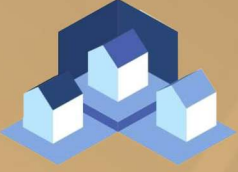

**VK BUILDERS**  
quality . stability . trust

ఖమ్మం జిల్లాలో, సెల్ ఫోన్ వ్యాపారంలో అత్యంత ప్రజాదరణ కలిగిన..  
హైటెక్ మొబైల్స్ వారి అధ్వర్యంలో ...

a member of  
**CREDAI**



**A PLEASANT SPACE WITH  
HAPPINESS  
AND LUXURY**



2 & 3 BHK LUXURY RESIDENTIAL FLATS | HIGH POTENTIAL FOR RENTAL RETURNS

**PROJECT PROMOTED BY REPUTED BUILDERS WITH VAST EXPERIENCE**



MORE SPACE  
MORE HAPPINESS  
WITH QUALITY



 45 FLATS  
2 & 3 BHK

 63,250 SQ.FT.  
APARTMENT

 PLAY  
AREA

 24/7  
SECURITY



Our project designed with masterly touches to meet the aspirations of today's generation. You will discover that it is the dream home you always wanted to live in. All floors are designed to provide independent living units without common walls and with all modern amenities for luxury living in Khammam. The amenities include, spacious common areas, lobby, balconies, ample storage spaces, excellent ventilation, round the clock security and plenty of water.

### PROJECT HIGHLIGHTS

- The largest Residential project at more precious corner at Khammam City with 100% Vaastu.
- The project built according to municipal 100 % corporation norms.
- The deluxe quality project is very near to Lakaram tank bund, colleges, schools, hospitals, IT HUB, shopping malls and automobile showrooms.
- SBIT Engineering College, Beside of sri chaitanya E-techno School, Mamatha Hospital
- The project is completely secured with CCTV, and provided with intercom facilities.
- Due to excellent ventilation one will feel calm and peaceful Atmosphere.
- Due to excellent ventilation one will feel calm and peaceful Atmosphere.
- Bore water softener and mineral water plant.
- Children's play area.
- Prime Residential Area
- Quality Construction
- Earth Quake Resistance
- Generator backup
- Parking flooring VDF.
- One car parking for each flat



Happiness is word that defines the feeling of fulfilment. It's a state of mind that homes positivity & contentment. Happiness is a destination where faces find smiles and hearts attain pleasures and it becomes a promise when life celebrates all these emotions for a lifetime, coming to you on right time.

Welcome VK Suraksha apartment, a name synonymous to home. An address that enhances your views and connects you to conveniences. A destination of dreams promising high pleasures as well as big space for your well-being. A luxury home that ushers the most satisfying life to cherish forever & ever. It's time to live where quality is a promise.

**TYPICAL FLOOR PLAN - AREA STATEMENT IN SFT**

FLAT NO	01	02	03	04	05	06	07	08	09
SBA	1820	1260	1260	1450	1190	1440	1260	1260	1710
TYPE	3 BHK	2 BHK	2 BHK	3 BHK	2 BHK	3 BHK	2 BHK	2 BHK	3 BHK
FACING	WEST	WEST	WEST	WEST	NORTH	EAST	EAST	EAST	EAST

**MASTER PLAN**

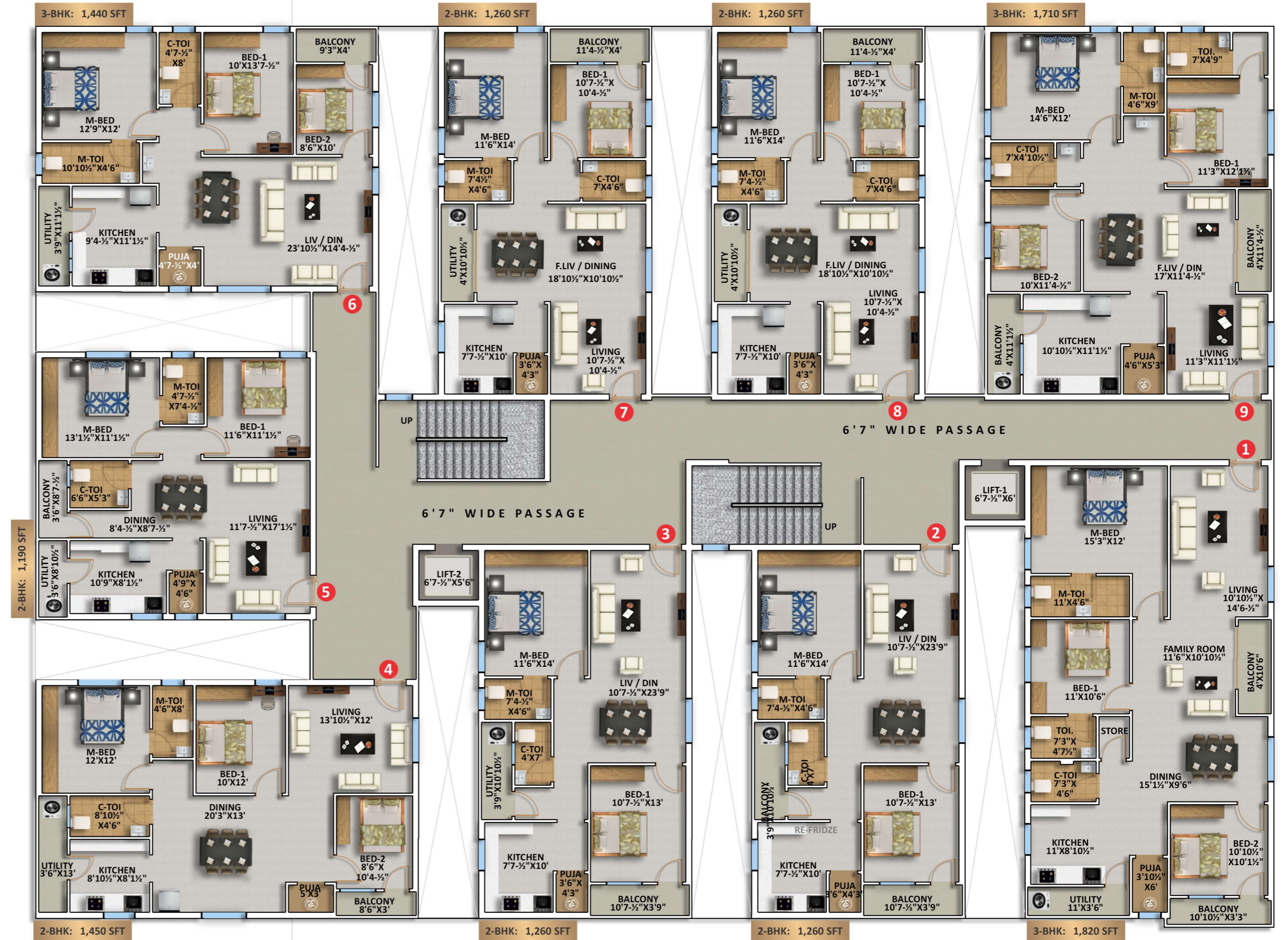



F NO. 01 - 1820 SFT - 3 BHK - EAST



F NO. 02 - 1260 SFT - 3 BHK - WEST

## EXPERIENCE SPACE LIKE NEVER BEFORE



F NO. 04 - 1450 SFT - 2 BHK - WEST



F NO. 05 - 1190 SFT - 2 BHK - NORTH



F NO. 06 - 1440 SFT - 3 BHK - EAST



F NO. 07 - 1260 SFT - 2 BHK - EAST



VK Suraksha is an elegant combination of superior exteriors and superlative interiors. Every home is an epitome of flawless finesse, every element, planned to the minutest detail and executed with perfection. With all modern facilities and premium specifications in place, VK Suraksha is the space and were looking for all this while

A residence where every aspect has been carefully considered to create a refuge from the pressures of modern urban living and encourage a more relaxed outlook life. At Vk Suraksha every home within.



F NO. 09 - 1710 SFT - 3 BHK - EAST

## 3D ISOMETRIC VIEWS

**STRUCTURE :**  
RCC framed structure with stilt + five floors.

**SUPER STRUCTURE :**  
Brick work in cement mortar with table moulded red brick/ light weight bricks.

**PLASTERING :**  
Wall care finishing for interior walls in bedrooms, hall, dining, kitchen, puja room and corridor areas. Sponge finish for external walls.

**CEMENT:**  
Mahacemnt / Chettinadu Cement

**DOORS :**  
**Main Door :** 6'X4' best teak wood frame, teak wood shutters with carving (Matte Finished) and best quality hardware fittings.  
**Internal Door :** Teak frames with flush doors- laminated.

**FLOORING:**  
Premium quality 800mm X 800mm tiles In living and dining areas, 600mm X 600mm tiles in bedrooms and kitchen. Steps SS Railing

**KITCHEN:**  
Granite platform with stainless steel sink, 2' glazed tile dado above the kitchen platform.

**WINDOWS:**  
UPVC Windows – powder coated frame with 5mm glass, mosquito mesh and safety grills.

**TOILETS:**  
Anti skid floor tiles, designed dado tiles up to 7 feet height, parryware / CERA or equal quality sanitary fixtures along with health faucet, hot and cold water mixer and shower Jaquar / CERA Tabs

**WATER SUPPLY:**  
1) Water supply through bore well with softeners, provision for municipal water supply  
2) Drinking water supply through RO plant. by carrying water cans.

**ELECTRIFICATION:**  
3 Phase power supply with individual meters, MCB's for each distribution board with concealed copper wiring of Finolex / polycab brand, provision for power outlets for air conditioners in all bedrooms, geysers in all bathrooms, 16 amps outlets in kitchen and for washing machine and also wherever required. provision for cable & TV in living and master bedroom. Switches GM

**PAINTING:**  
Two coats of Asian Paints emulsion over putty Birls/ JK finished surface and external paints for external walls.

**PLUMBING:**  
Ashirvad CPVC pipes, CERA / Jaguar fixtures.

**SECURITY:**  
CCTV surveillance will be provided in common areas, intercom from security to all flats.

**GENERATOR:**  
Kirlosker / Ashok Leyland

**LIFT:**  
2nos 5 Passenger will be provided. Johnson or Kone Equivalent make.

**SHELVES:**  
RCC shelves in kitchen and bedrooms – 200 Sq. Ft.

## OUR COMPLETED PROJECTS



**VK TOWERS**



**VK AAVAS**



**Developer Address**  
VK BUILDERS, Kolipaka Complex,  
Mayuri Center, Khamam - 507001.

**Site Address**  
VK Suraksha Apartment,  
Beside Sri Chaitanya E-Techno School,  
Mamatha Road, Khamam - 507001.

**For more Details Contact:**  
**P. NAGA RAMESH:**  
Managing Director  
**+91 70133 80664**  
**Off: 98490 65210**  
**vkbuilders4567@gmail.com**  
**www.vkbuilderskmm.com**

**Follow Us @**  
<https://www.facebook.com/21417077924262/posts/815109355815265/>  
<https://www.linkedin.com/in/vk-builders-1a241721b/>  
<https://www.instagram.com/vkbuilders9/?hl=en>

**Architect & Engineers**  
  
**RICKKRAFT PLANNERS**  
 ARCHITECTS & INTERIOR DESIGNERS  
 # 101, H.No. 6/2 RT,  
 LIG Panjagutta Colony,  
 Lane beside Aggarwal Eye Hospital,  
 Hyderabad - 500 082  
 M: 94931 79152  
 E: ar\_richkraft@yahoo.com

*Note: This brochure is only a conceptual presentation of the project and not a legal offering. The promoters reserve the right to alter and make changes in elevation, specifications and plans as deemed fit.*